



# X10 2-WAY ACTIVE LINE SOURCE

---



**[www.qanon-audio.com](http://www.qanon-audio.com)**



# SAFETY INSTRUCTIONS

## **1. Read this document**

## **2. Pay attention to all safety instructions and hazards and obligatory warnings**

## **3. Do not use equipment or accessories that are not approved by QANON AUDIO.**

## **4. Attention to Sound Level**

Do not approach the speaker when operating, and consider wearing earplugs.

Speaker system can produce very high sound pressure level (SPL), which can be instantaneous.

It results in permanent hearing impairment to performers, producers and audiences.

Listening can take place for a long time:

8 hours 90 decibels (A-weighted), 30 minutes 110 decibels (A-weighted), less than 4 minutes 130 decibels (A-weighted).

## **5. Read the manual before operating the product.**

Use speaker system components described in user manual and follow instructions

## **6. Read the rigging manual before installing the product.**

Use the hanging accessories described in the installation manual and follow the relevant procedures.

## **7. Before repairing the product, please read the "Maintenance" section of this document.**

## **8. Do not expose products to extreme conditions**

Do not expose the product to rain or waves.

Do not expose the product to humidity (fog, steam, humidity, cooling, etc.) or overheating (direct sunlight, radiator...) For a long time

## **9. Do not store products on unstable carts, brackets, tripods, brackets or tables.**

## **10. Maintain this document as an integral part of the product**

Put this document in a safe place.

Record any services of the product in the maintenance section of this document

Do not resell products without this update document

Thank you for purchasing QANON AUDIO #X10. The container shall contain - 1 #X10 enclosure. Each QANON AUDIO #product has been tested and inspected before it leaves the factory and should arrive intact. Carefully open the container and check for any apparent damage. If so, inform the transport company or distributor immediately. Only the consignee can claim against the carrier for damage in transit. Cartons and packing materials must be kept for inspection by carriers. Read this document carefully to familiarize yourself with the product and identify external documents that contain basic information on correct and safe installation and operation of the product. All the documents described below can be accessed free of charge on the QANON AUDIO < website ([www.qanon-audio.com](http://www.qanon-audio.com)).

As part of the continuous development of technology and standards, QANON AUDIO reserves the following rights:

**Change product specifications and document contents without prior notice. Please visit the QANON AUDIO website regularly to download the latest updates of documents and software.**



# X10 2-WAY ACTIVE LINE SOURCE

---



- Maximum SPL 137dB
- 1 x 10" Neodymium LF driver unit
- 1 x 3" Neodymium HF driver unit
- 100° horizontal
- Adjust angle 0°, 2°, 4°, 6°, 8°, 10°, 12°
- Rigging or ground stacking integrated assembly system
- Low frequency limit extends to 60Hz
- Add X10Sub Extended low frequency
- Add Xiv18 / Xiv28 subwoofer system
- C15/VDA/H Series amplifier controller

The X10 enclosure is a line array loudspeaker with adjustable angle.

The X10 has an 10-inch speaker mounted in a bass reflector and a 3-inch diaphragm compression driver with a waveguide tube

The X10 enclosure is based on 2-way designs, one low-frequency and high-frequency band. The rated impedance of the low-frequency is 16ohms, and the rated impedance of the high-frequency is 16ohms.

The X10 enclosure is made of Baltic birch plywood to ensure maximum acoustic and mechanical integrity.

The 3-point suspension system is integrated in the enclosure, and the X10 enclosure works in the rated frequency range of 60Hz -20kHz. The frequency response system can be extended to 40Hz or 30Hz, and special X10 Sub extended bass, Xiv18 or Xiv28 subwoofer are added respectively. X10 produces a 100°symmetrical horizontal coverage. The suspension system allows vertical assembly of different box angles up to 6 degrees, forming a line array with variable parameters to ensure a perfect acoustic effect.

The X10 system is driven by C15 / H series / VDA power amplifier controller to ensure the linearization of passive system, the protection of loudspeaker and the optimization of loudspeaker system in different operations. The acoustics of the system will depend on the preset and selected physical configuration.

The X10 has a smooth frequency and phase response. The combination of a 1x3 HF and a 1x10" LF provides an extremely high sound pressure/volume ratio. The low frequency part uses a specially designed phase plug to reduce interference between the two units, improving directivity and increasing sensitivity. A coherent planar sound wave is formed without generating acoustic diffraction, thereby achieving superior coverage control and high fidelity sound effects. This advanced drive unit design allows each individual cabinet module to be perfectly acoustically coupled to form an almost continuous and truly coherent line source.

**[www.qanon-audio.com](http://www.qanon-audio.com)**



## X10 Technical Specification

### X10 Technical Specification

Type	2-way active Line Source enclosure
Frequency Response(Preset)	60Hz-20kHz(-10dB)
Horizontal	100°
Angle Increments	0° 2° 4° 6° 8° 10° 12°
Drivers	LF:1×10" Neodymium HF:1×3" Neodymium
Handling Power (AES)	LF:250W HF:110W
Maximum Peak SPL	137dB/1m
Nominal Impedance	LF:16Ω / HF:16Ω
Connections	2 x NL4 SpeakOn
Pin Connections	NL4=LF: +1-1 HF: +2-2
Height Front	300mm
Height Back	220mm
Width	500mm
Depth	380mm/440mm
Weight	17kg / 37.5lb

### Rigging and Handling

Handle	4 ergonomic handles
Antiskid	2 ground runners
Fastener	3 side fastener

### Physical Data

Material	Baltic Birch Plywood
Finish	Black
Front	Polyester powder-coated steel grill
Rigging	Steel
Protection rating	IP45

## Dimensions CAD

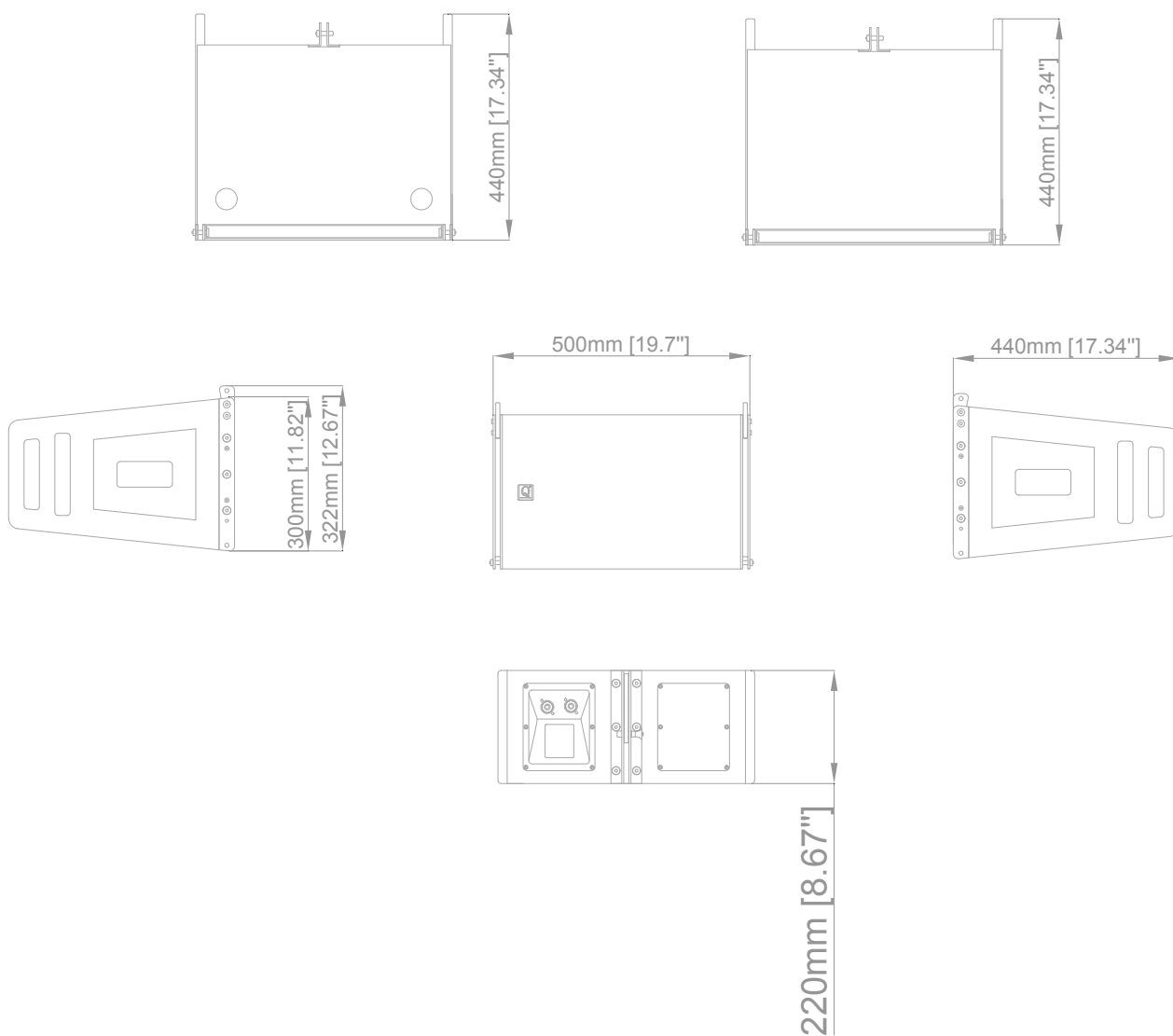



## Application

The X10 line array system is designed and applied with at least 2 units/group, providing fast and simple ground stacking applications. The X10 line array system can be built to meet the needs of vertical coverage angle in the form of straight lines or curves, which can be used for large-scale site activities with extremely high level requirements. X10 uses multiple configurations of up to 12 speakers per group, and 3-point hoisting method is also adopted for hanging parts. 4mm steel (synthetic width is 18 mm) and 8mm steel connecting rod are used. When 12 speakers are hoisted, the safety factor of hanging parts is 6:1. The X10 can be integrated with the X10Sub extended woofer speaker suspension system, integrated with the X10Sub woofer or integrated with the ground stack to enhance the system's low frequency response. The Xiv18 / Xiv28 speakers are used as ultra low frequencies for quick and easy lifting or Ground stacking integration.

X Series Line Array X12 / X10 / X8 (Incremental Consistency)

Adjustable degrees: 0°, 2°, 4°, 6°, 8°, 10°, 12°

## Type (stander type, Rigging type)

---

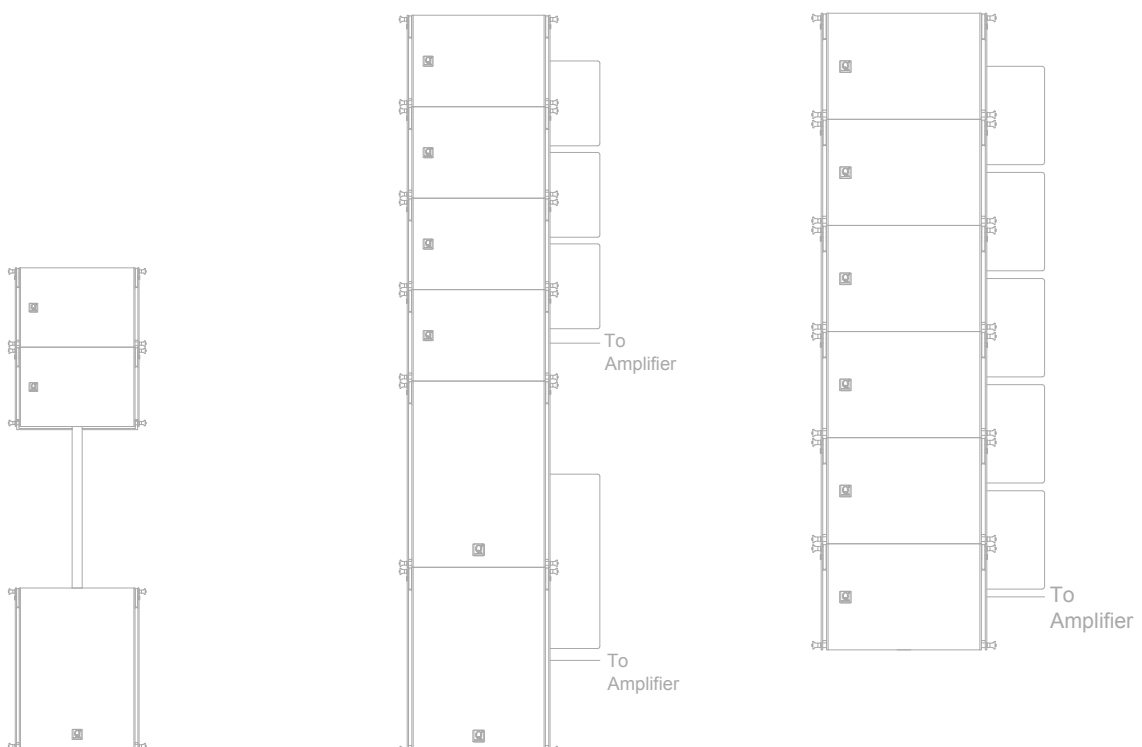



## H Series Maximum number of enclosures per Amp

Enclosure	Max enclosure in parallel	Max enclosure per controller
X8	4	4
X10	4	4
X12	4	4
X8Sub	2	4
X10Sub	2	4
X12Sub	2	4
Xiv18	2	4
Xiv28	1	2

## C / VDA Series Maximum number of enclosures per Amp

Enclosure	Max enclosure in parallel	Max enclosure per controller
X8	4	8
X10	4	8
X12	4	8
X8Sub	2	8
X10Sub	2	8
X12Sub	2	8
Xiv18	2	8
Xiv28	1	4

Enclosure	1	2	3	4
X8	LF:16 $\Omega$ / HF:16 $\Omega$	LF:8 $\Omega$ / HF:8 $\Omega$	LF:5.3 $\Omega$ / HF 5.3 $\Omega$	LF:4 $\Omega$ / HF:4 $\Omega$
X10	LF:16 $\Omega$ / HF:16 $\Omega$	LF:8 $\Omega$ / HF:8 $\Omega$	LF:5.3 $\Omega$ / HF 5.3 $\Omega$	LF:4 $\Omega$ / HF:4 $\Omega$
X12	LF:16 $\Omega$ / HF:16 $\Omega$	LF:8 $\Omega$ / HF:8 $\Omega$	LF:5.3 $\Omega$ / HF 5.3 $\Omega$	LF:4 $\Omega$ / HF:4 $\Omega$
X8Sub	LF:8 $\Omega$	LF:4 $\Omega$	None	None
X10Sub	LF:8 $\Omega$	LF:4 $\Omega$	None	None
X12Sub	LF:8 $\Omega$	LF:4 $\Omega$	None	None
Xiv18	LF:8 $\Omega$	LF:4 $\Omega$	None	None
Xiv28	LF:4 $\Omega$	LF:2 $\Omega$	None	None

NL4 4-Pin 4*4 <sup>2</sup>	X8 / X10 / X12	
Transducer connectors	LF = +1-1 HF = +2-2	
NL4 4-Pin 2*4 <sup>2</sup>	X8Sub / X10Sub / X12Sub	
Transducer connectors	LF = +1-1	
NL4 4-Pin 2*4 <sup>2</sup>	Xiv18 / Xiv28	
Transducer connectors	LF = +1-1	

## TRANSPORTATION ACCESSORIES

---

### **X10-Touring case:**

removable front case on wheels (two X10)



---

### **Rigging Frame Accessories**

**X10 / X10Sub-U Shackle (3' 5/8) 4t**



---

### **Rigging Frame with Extender Beam**

**X10 / X10Sub-Bump**



---

### **Speaker Cable**

**X10 4Pin NL4 4 x 4 mm<sup>2</sup> (50cm)**

**X10 4Pin NL4 4 x 4 mm<sup>2</sup> (2m)**

**X10 4Pin NL4 4 x 4 mm<sup>2</sup> (15m)**

**X10Sub 2Pin NL4 2 x 4 mm<sup>2</sup> (50cm)**

**X10Sub 2Pin NL4 2 x 4 mm<sup>2</sup> (15m)**







## D Series Processor Recommend

---



D36

D48

## H Series Controller Recommend

---

X10



X10Sub/Active



Xiv18



Xiv28



**H-800**  
2x800w 8ohm



**H-1200**  
2x1200w 8ohm



**H-1200**  
2x1200w 8ohm



**H-1800**  
2x1800w 8ohm

## Associated Enclosures

---

X8



X8Sub/Active



Xiv18



Xiv28

